

Designed to LGA

Use:

For water and sewage to max. 70°C.

Tests:

According to EN 12050-4:

Seat: 1.1 x PN
Body: 1.5 x PN

Low pressure test according to LGA

Options:

Ball of polyurethane for special applications

Materials:

Body and cover	Stainless steel, AISI 316
Cover gasket	NBR O-ring
Ball	Aluminium, NBR rubber lined
Bolts, nuts and washers	Stainless steel, A4



Designed to LGA

- Component list
1. Cover

2. Bolt/nut/washer

3. Gasket

4. Body

5. Ball

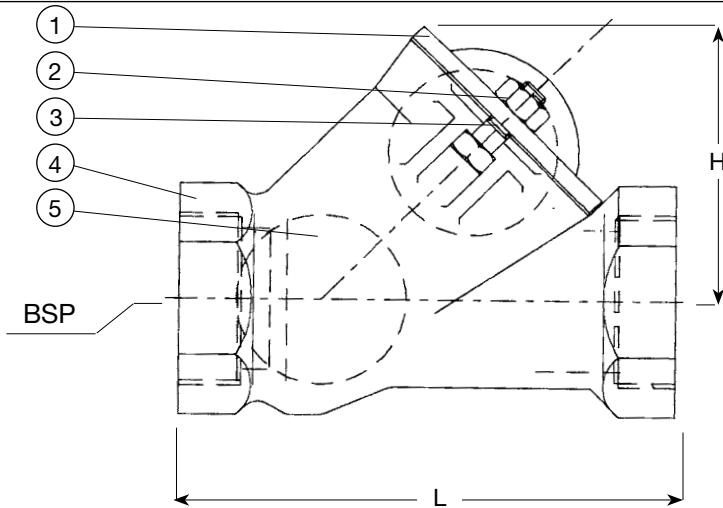

Pressure loss

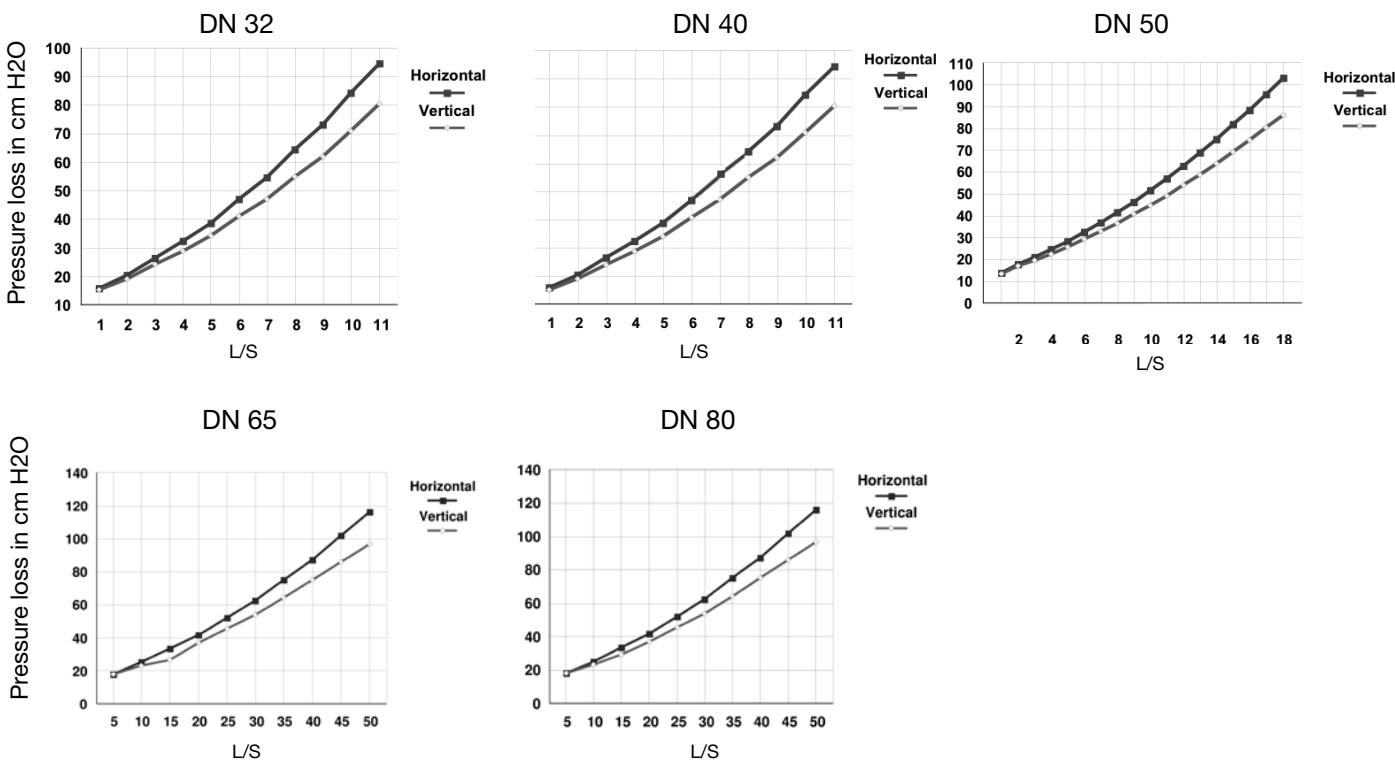

Ref. nos.	DN	L mm	BSP thread	H mm	D ball mm	Weight kilos
53-032-409090	32	140	1 1/4"	83	48	2.0
53-040-409090	40	140	1 1/2"	83	48	2.0
53-050-409090	50	180	2"	101	60	3.0
53-065-409090	65	245	2 1/2"	140	95	6.8
53-080-409090	80	260	3"	140	95	7.4